

Evo 100m* Wirefree Plug-In Chime Kit

Declaration
 Novar ED&S hereby declares that this wirefree chime kit is in compliance with the essential requirements and other relevant provisions of the Radio and Telecommunications Terminal Equipment (R & TTE) directive, 1999/5/EC

Instructions – Please retain these instructions for future reference

Pack contents:

- 100m Plug-In Chime 230v
- Bell push & CR2032 Lithium coin cell battery
- Adhesive pad, 2 x screws (ø3x20mm) 2 x wall plugs (ø5x25mm) for mounting the bell push

You will require:

- A small crosshead and flathead screwdriver, a ø5 masonry drill

1. Open the bell push

To open the front cover carefully insert a flat bladed screw driver, into the slot and twist gently. When refitting the front cover to ensure the weather proofing is maintained, always mount the bell push in the upright position and replace the cover securely. Fig 1

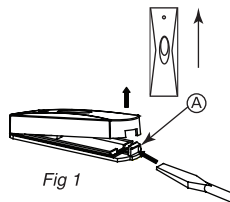

2. To fit or replace the battery

Open the front cover and insert the CR 2032 Lithium coin cell battery into the cover as shown in fig 2. Any debris created during installation must be removed from the base before fitting battery, to ensure good contact.

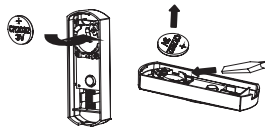

Fig 2

3. Mount the bell push

Ensure the wall surface is clean and dry. Mount using either the double sided sticky pad on a smooth surface, or the screws and wall plugs provided. See fig 3. Do not mount the push on or near (< 30cm) large metal objects, as it will block signals from the push.

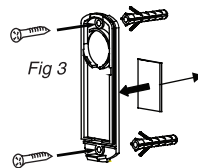

Fig 3

4. Test the bell push

When the bell push button is pressed, the confidence light B in fig 4, will illuminate to reassure the caller that the bell push is working. The light will flash 5 times when the battery needs replacing.



Fig 4

5. Use of the door chime

Plug the chime into any 220-240V BS 1363 socket, installed in a clean dry environment, situated within transmission range of the bell push, as shown in fig 5.

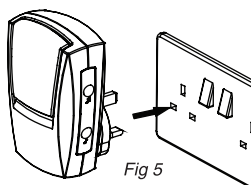

Fig 5

6. Automatic Programming of bell pushes

The first time a chime unit is powered up, the sounds available are demonstrated. Press the door push until the chime responds with a tune. You can leave this tune or change it to a desired tune by using button A (see fig 6) (see Sound Selection).

To programme a second push, press the push button until the chime sounds, then use button B to change the tune if required. Programming is now completed.

If more than 5 minutes has elapsed, you will have to reset the chime programming by pressing and holding buttons A and B until the chime sounds, this takes approximately 5 seconds. The chime can then be programmed to 1 or 2 door pushes.

All EVO and Décor Chimes and Bell Pushes use a self learning feature to ensure no interaction from other neighbouring systems.

7. Sound Selection

- A = Main push sound selection
- B = Second push sound selection

Chime tune options are as follows:

1. Mini Bell 2 Note (Default Tune for 1st Push)
2. Mini Bell 1 note (Default Tune for 2nd Push)
3. Flugel horn

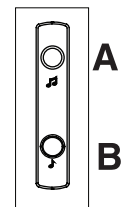

Fig 6

Trouble Shooting

Chime not Sounding

Chime may be positioned out of range of the bell push
 Move your chime closer to the bell push

A metallic object may be blocking the signal from bell push position
 Experiment with the location of the chime to see if you can move it in a more suitable place

The battery in the bell push may need replacing
 Press the bell push. If the confidence light flashes 5 times after being pushed, replace the battery.
Note: In cold conditions, poor location or environment, operating at maximum range it is advisable to replace the battery more frequently before the indicator light flashes (i.e every 12 - 18 months) to maintain optimum performance

Your bell push and chime haven't been programmed
 Reset the automatic programming of your chime and bell push

* The stated transmission range of this product is measured in open field conditions. Walls ceilings, and metal structures will reduce the maximum range.

Friedland guarantees this product for 3 years from date of purchase. Proof of purchase is required, this does not affect your statutory rights. If you require further information about our products, call the Friedland helpline on +44 (0)1268 563066.

Friedland a Novar business, Novar ED&S, The Arnold Centre, Paycocke Road, Basildon, Essex, SS14 3EA, England

www.friedland.co.uk

